

**Confortement de berges :
Caissons végétalisés**

**Confortement de berges :
Risberme + retalutage de la berge**

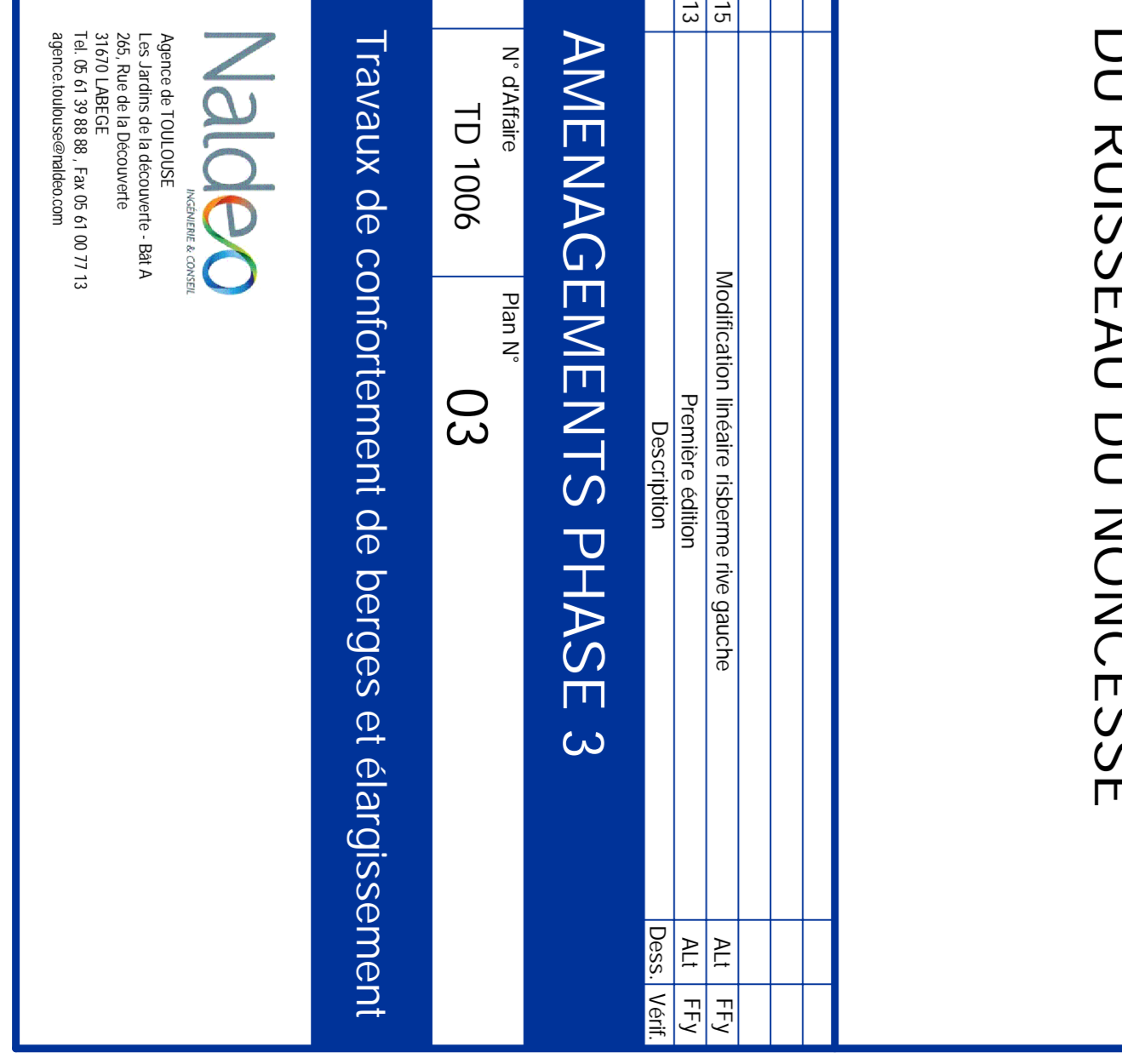
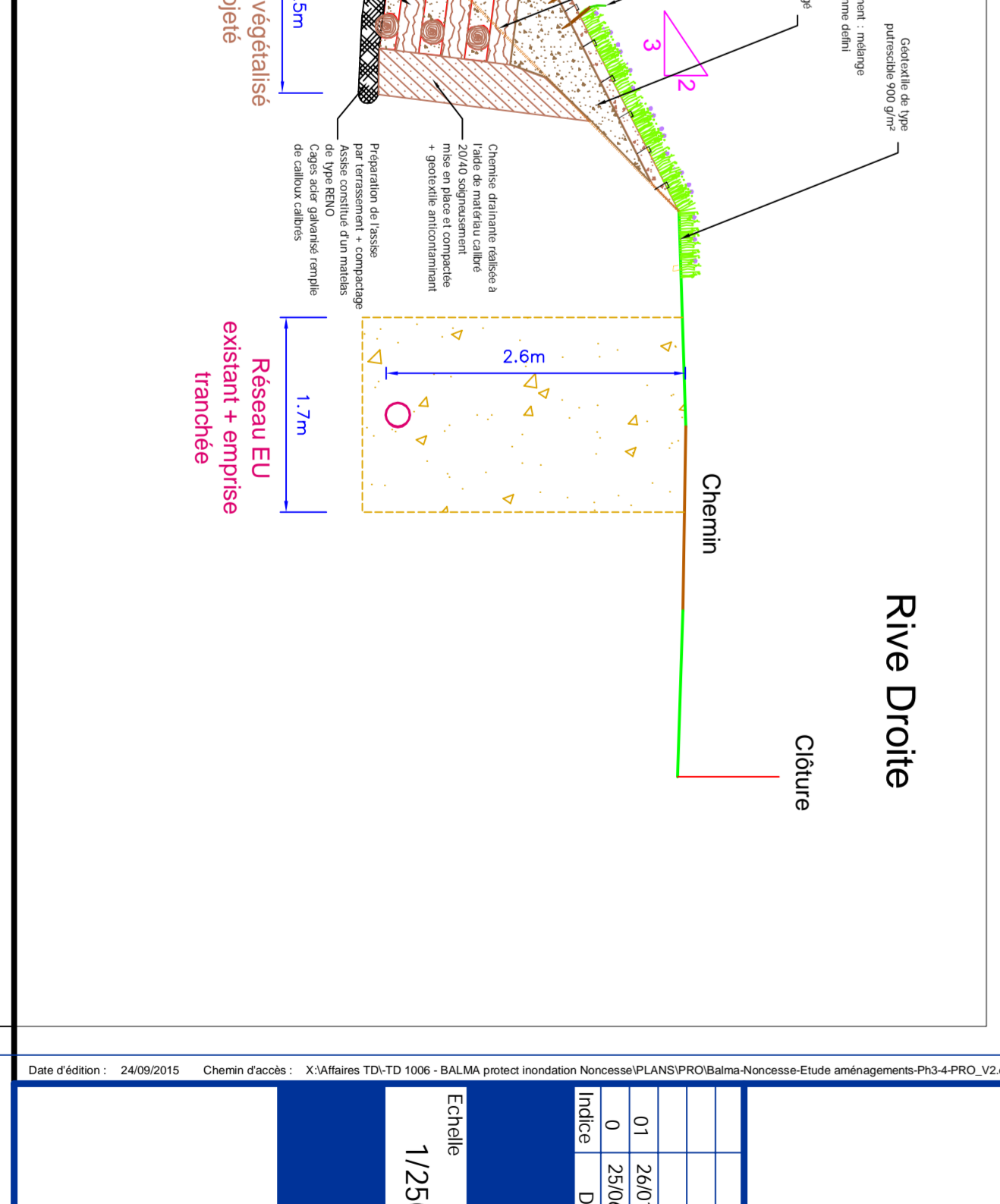
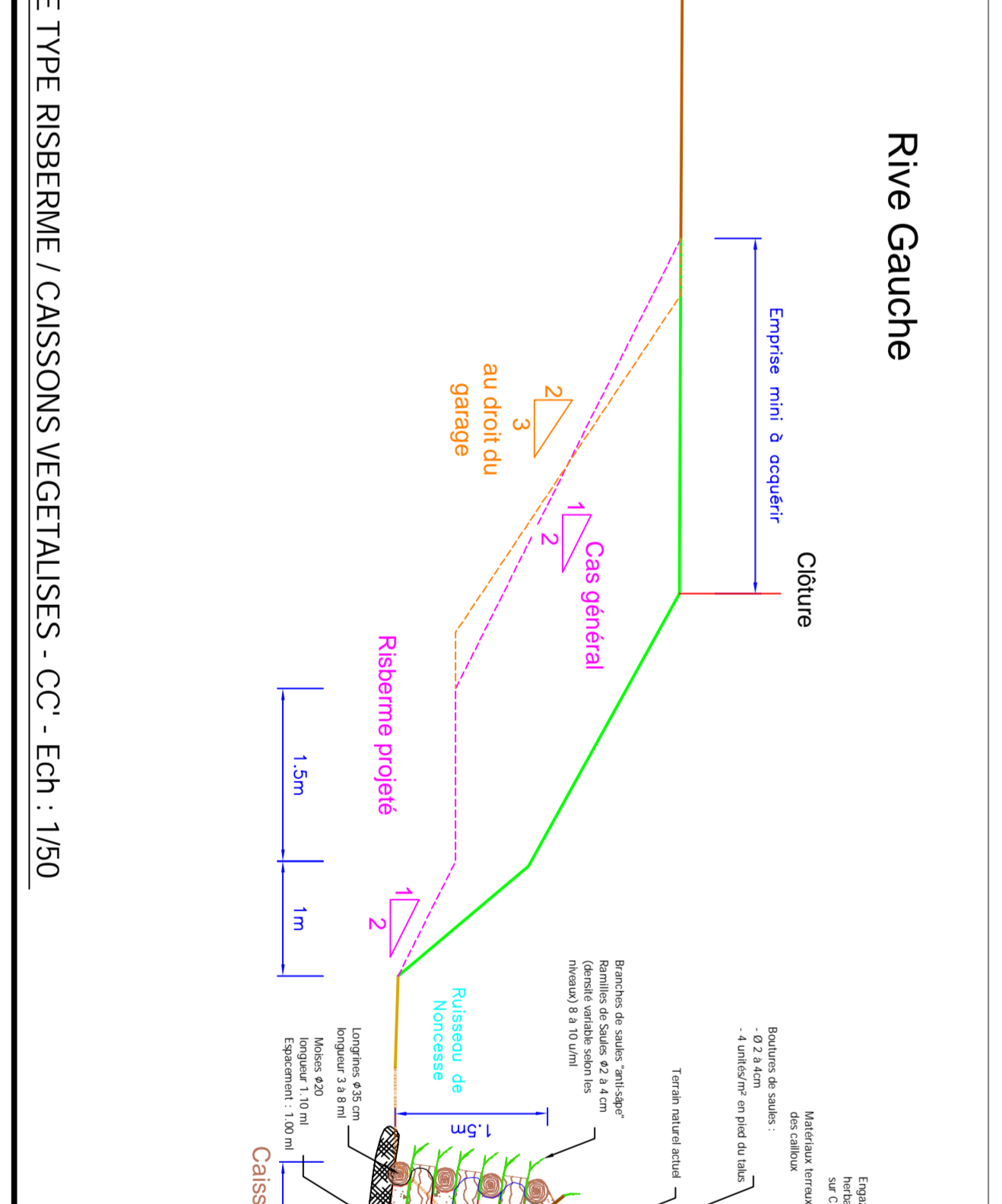
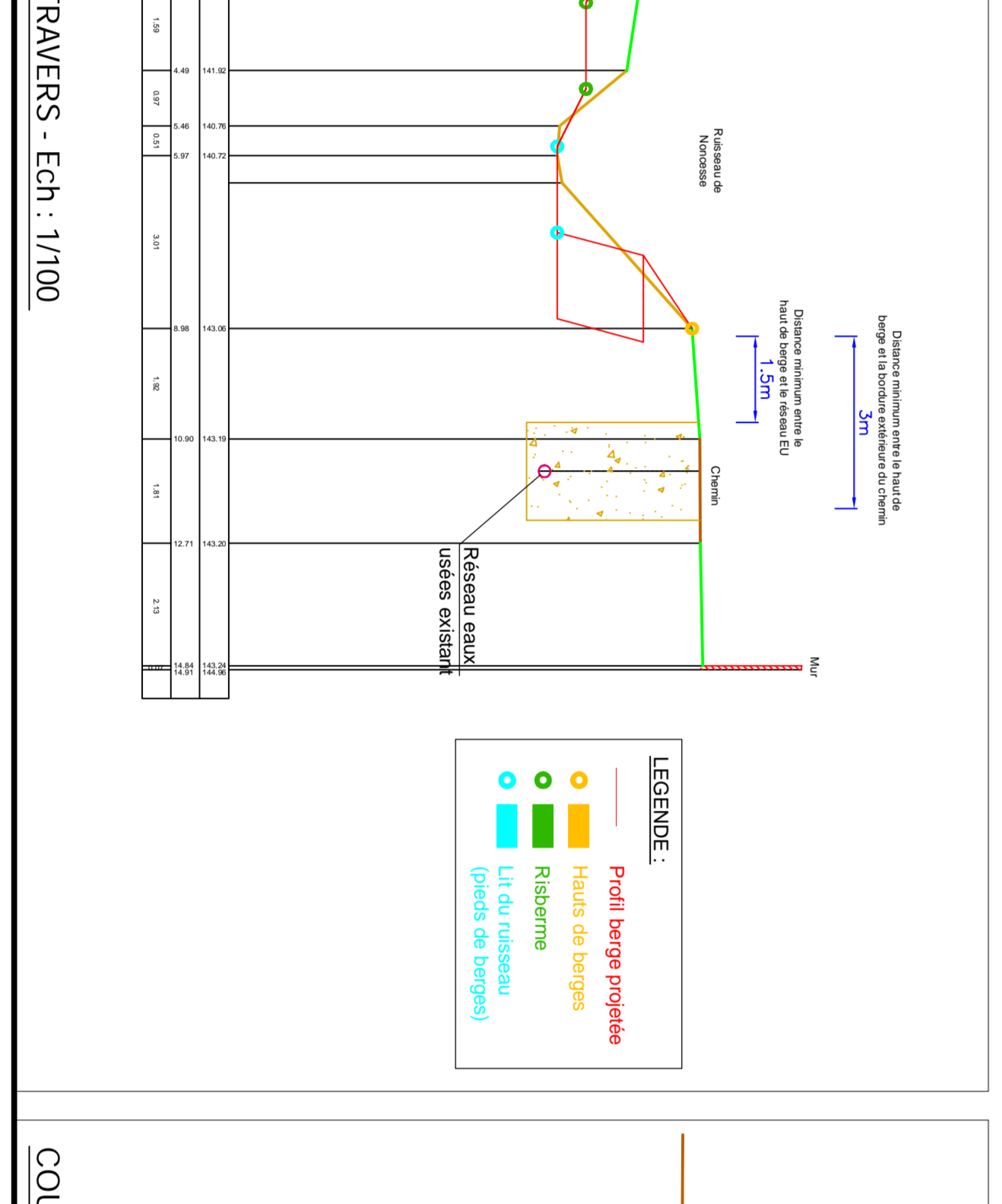
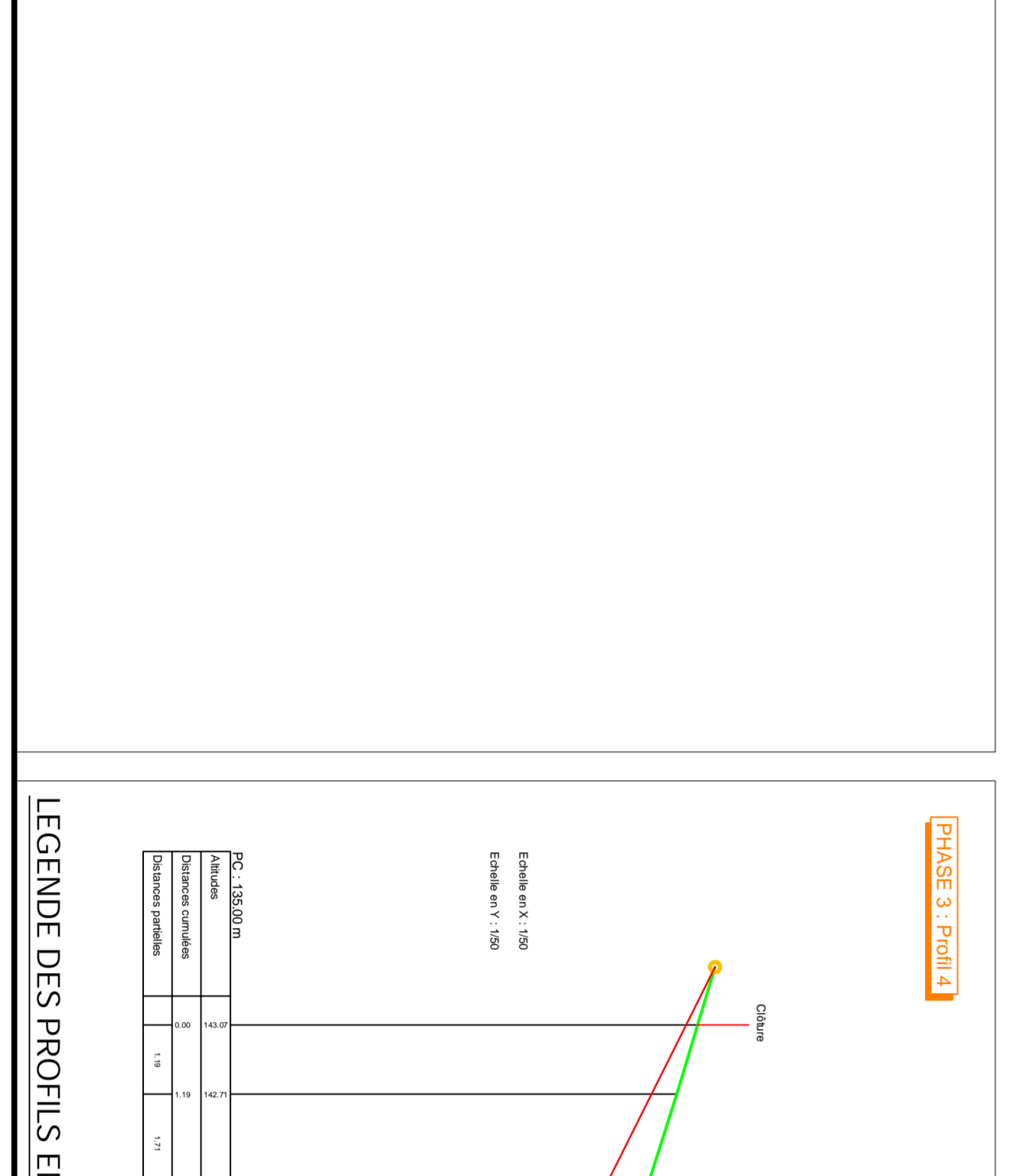
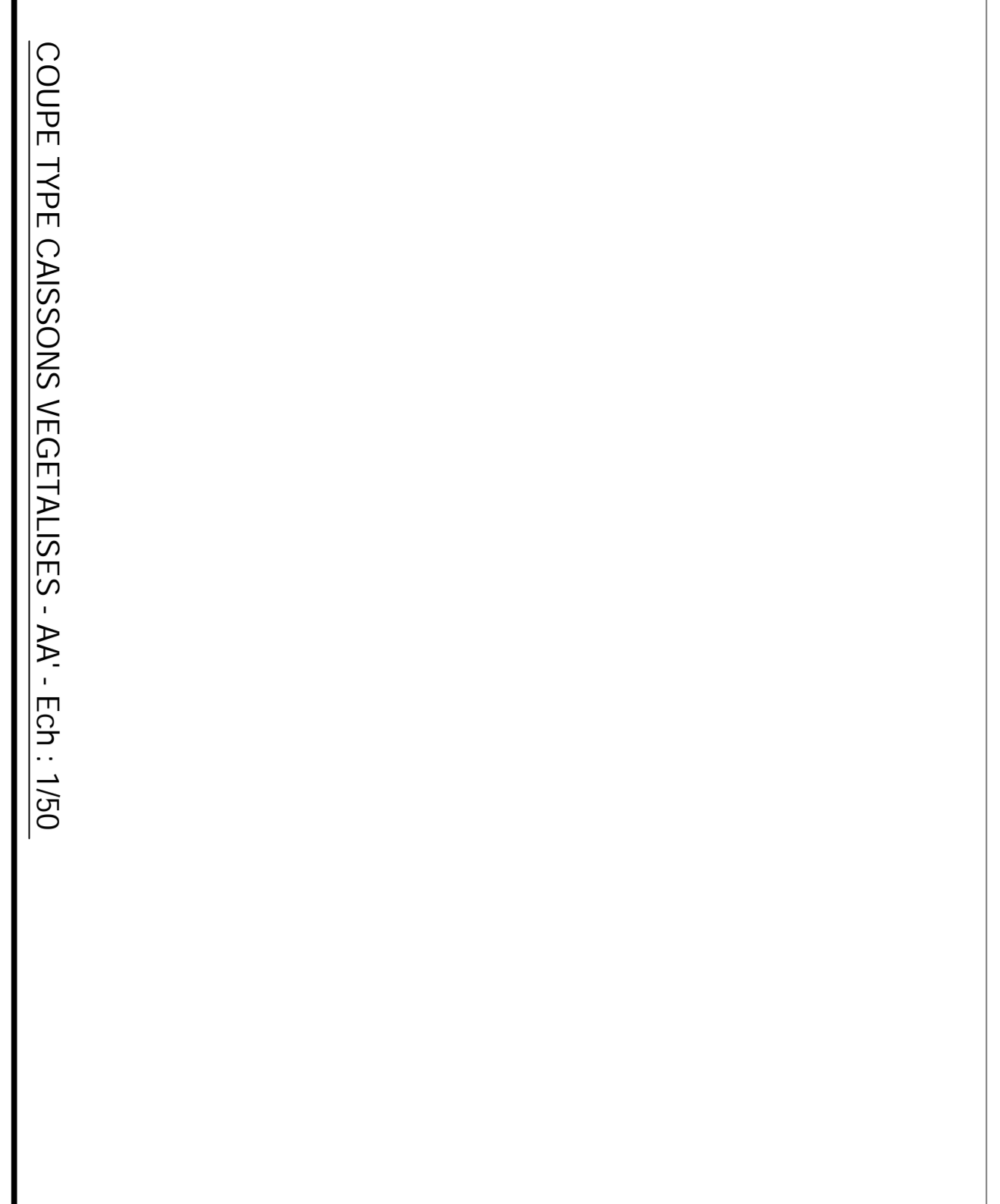
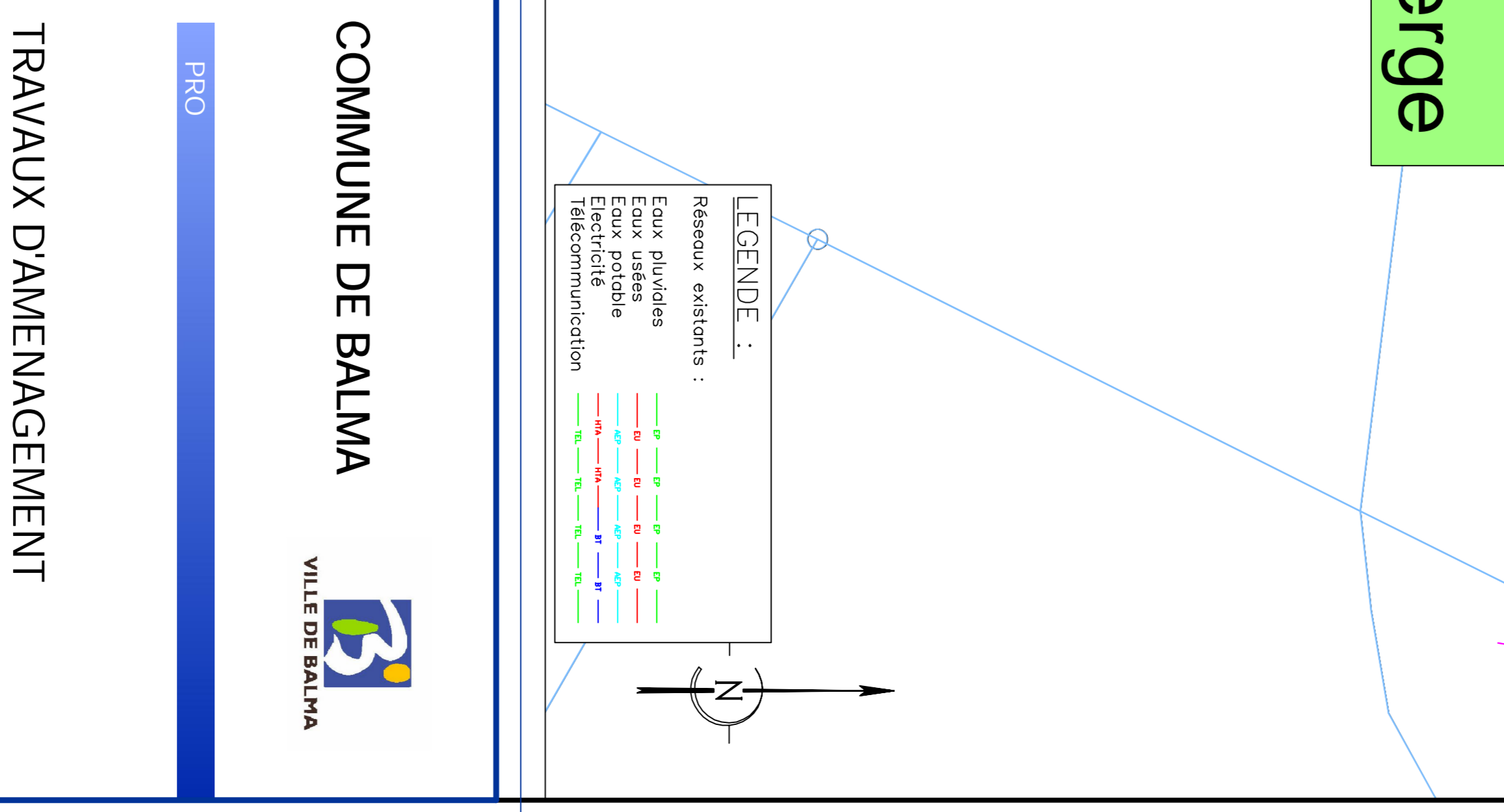
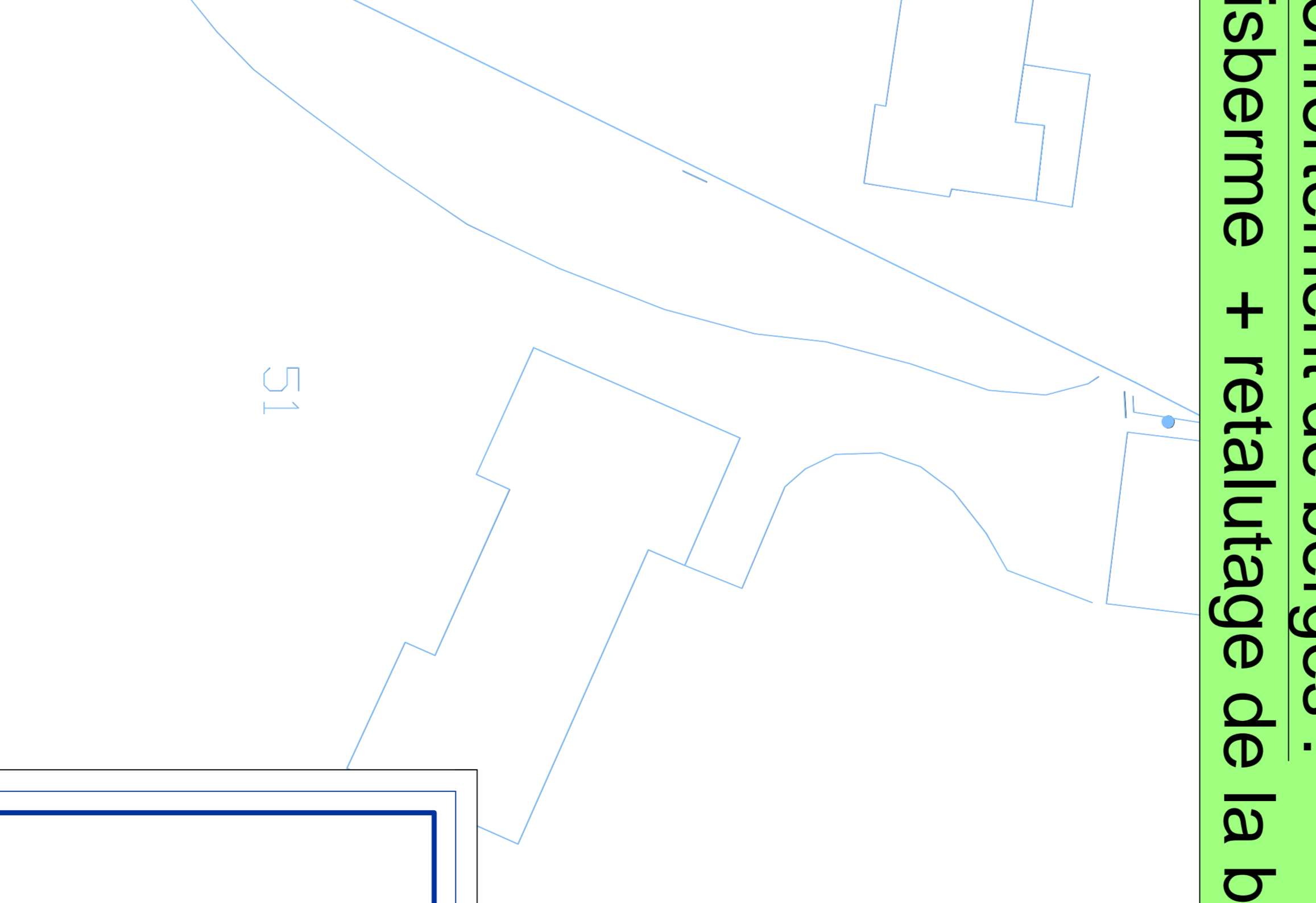
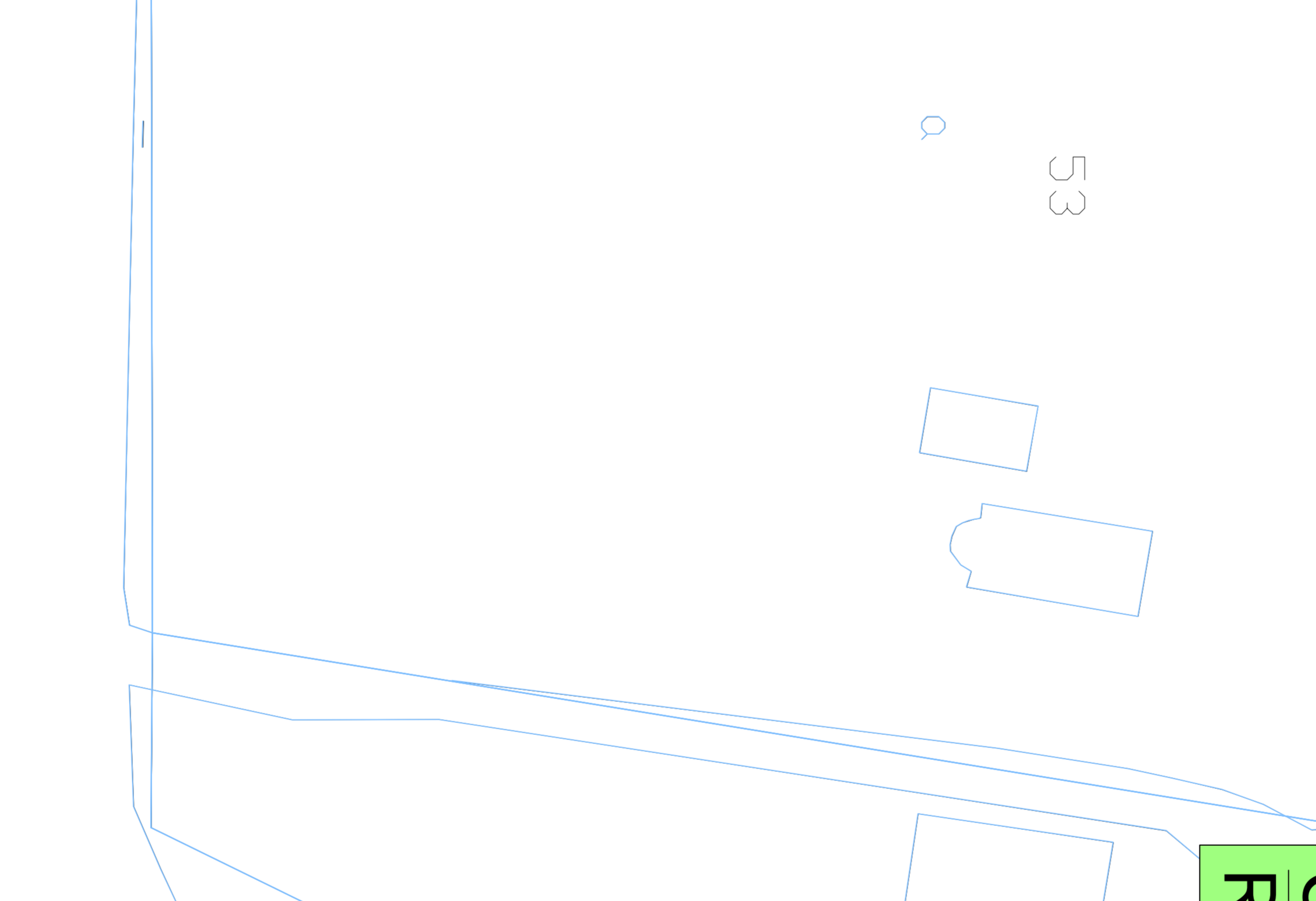
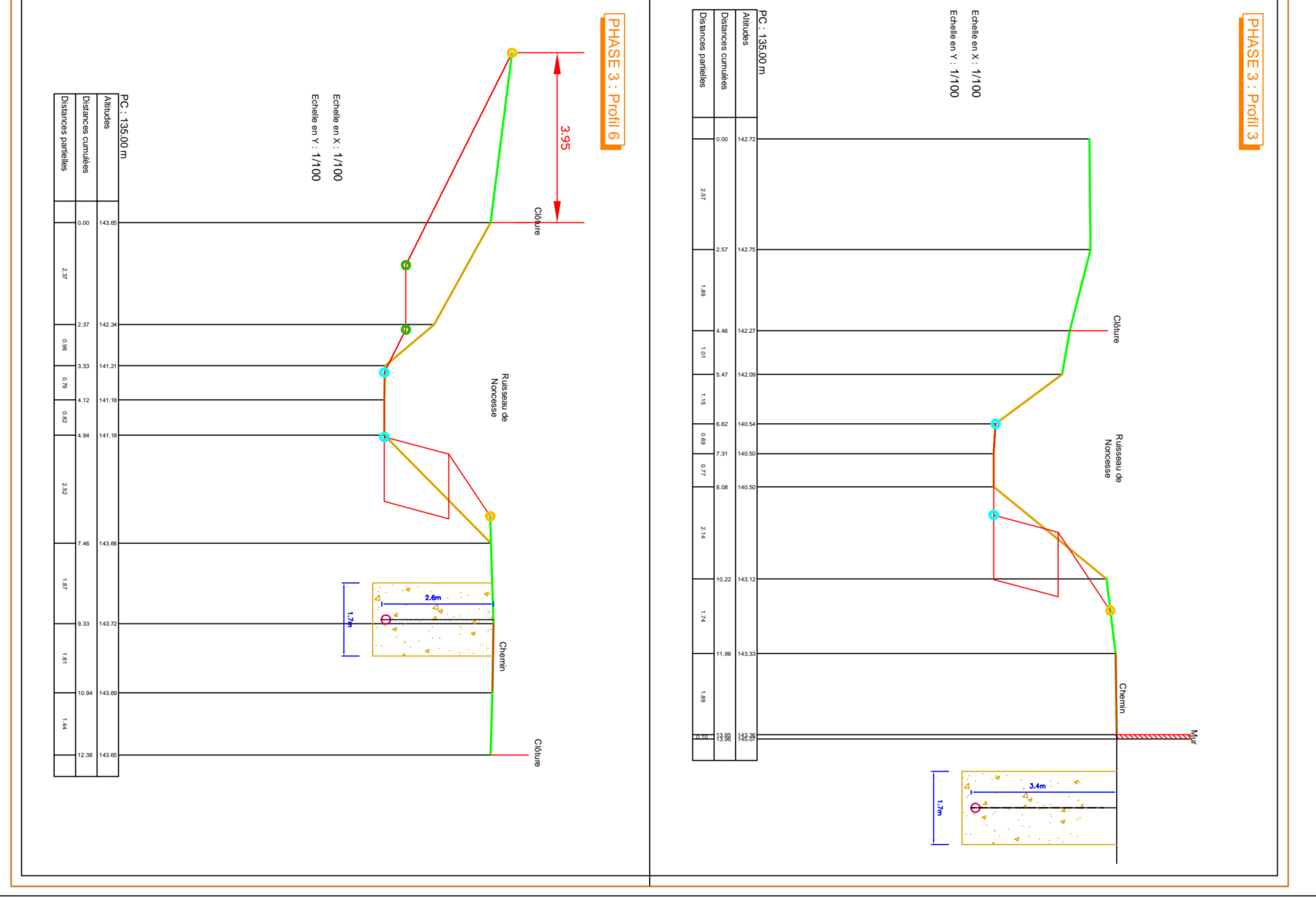
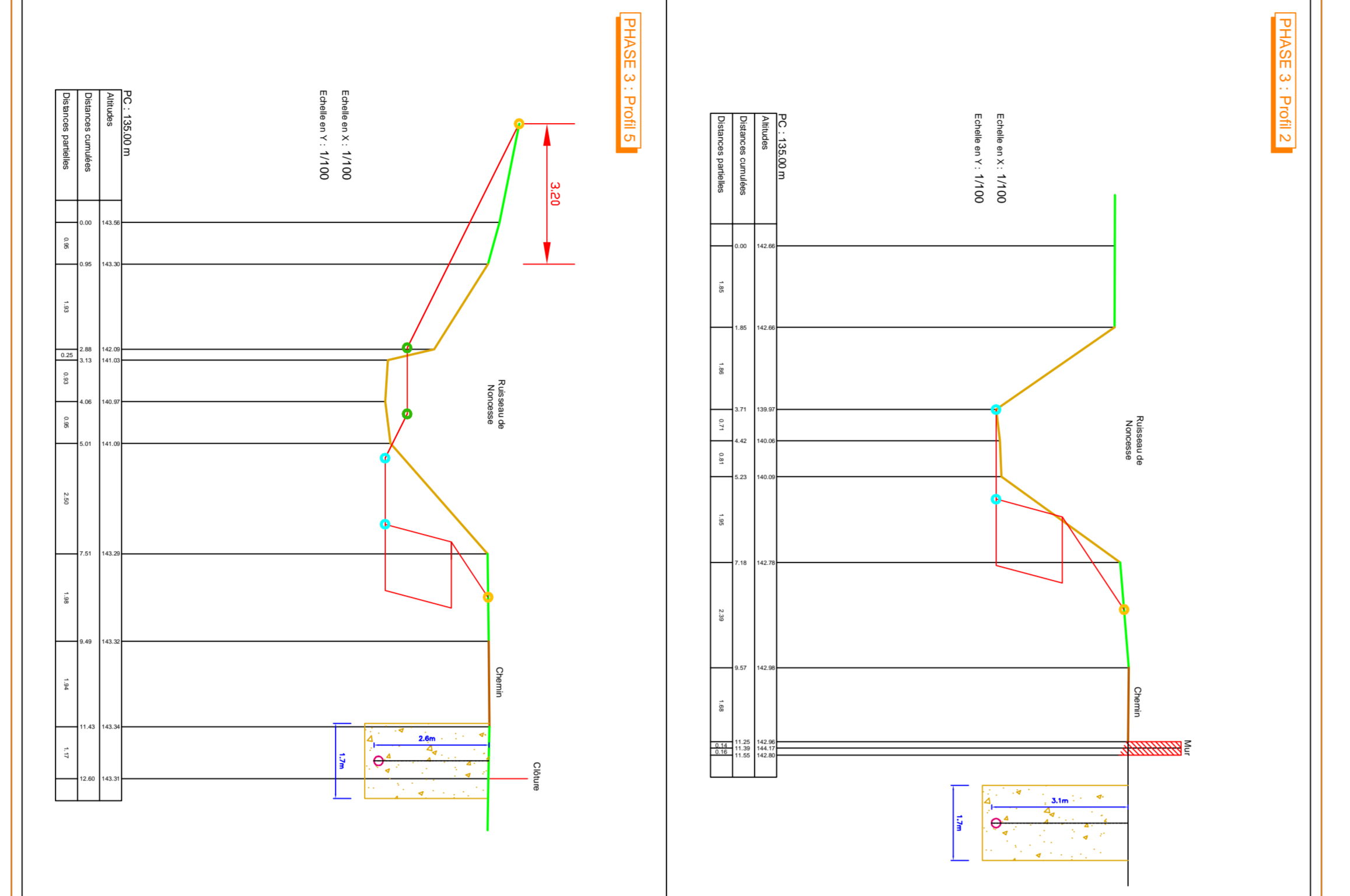
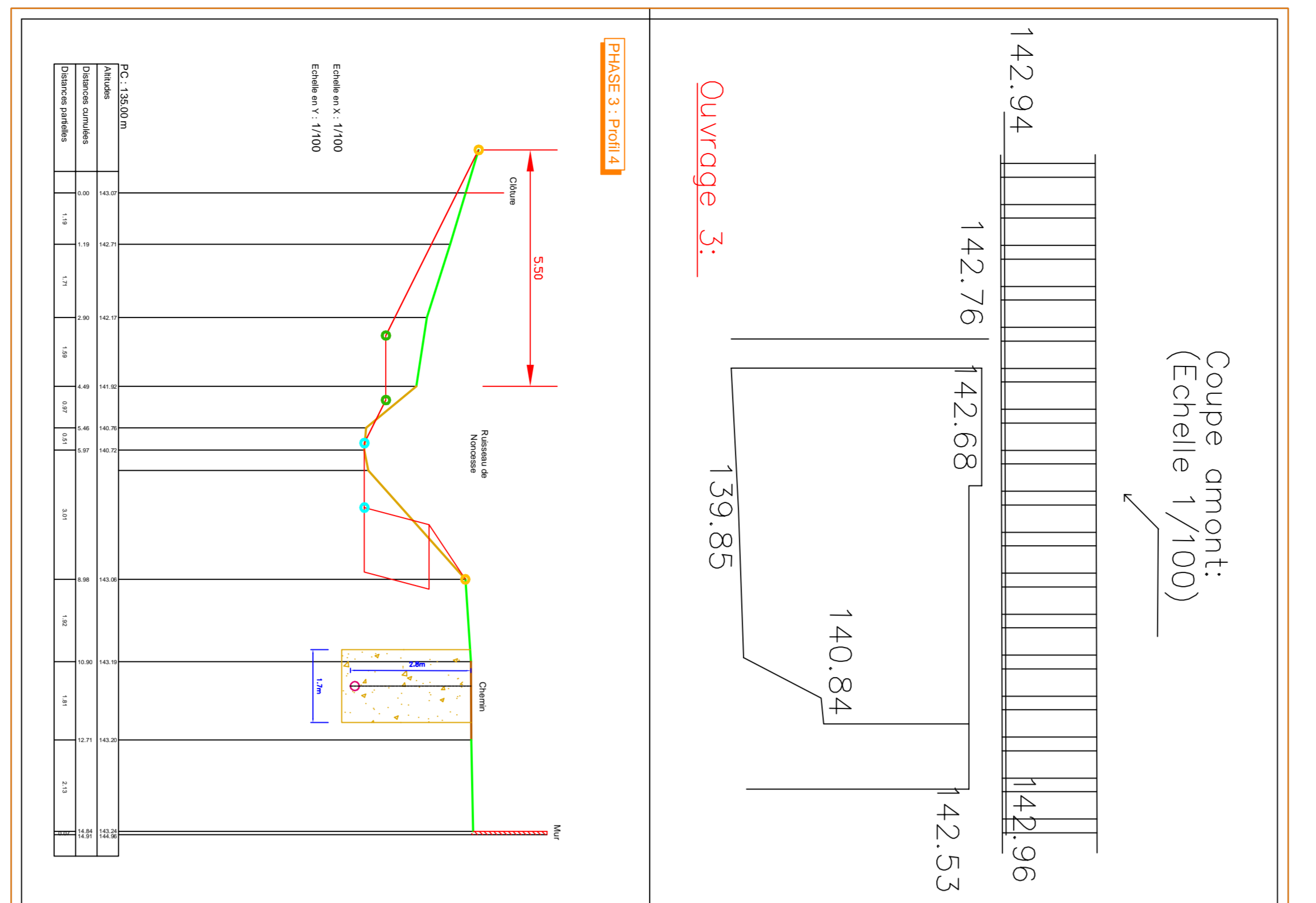
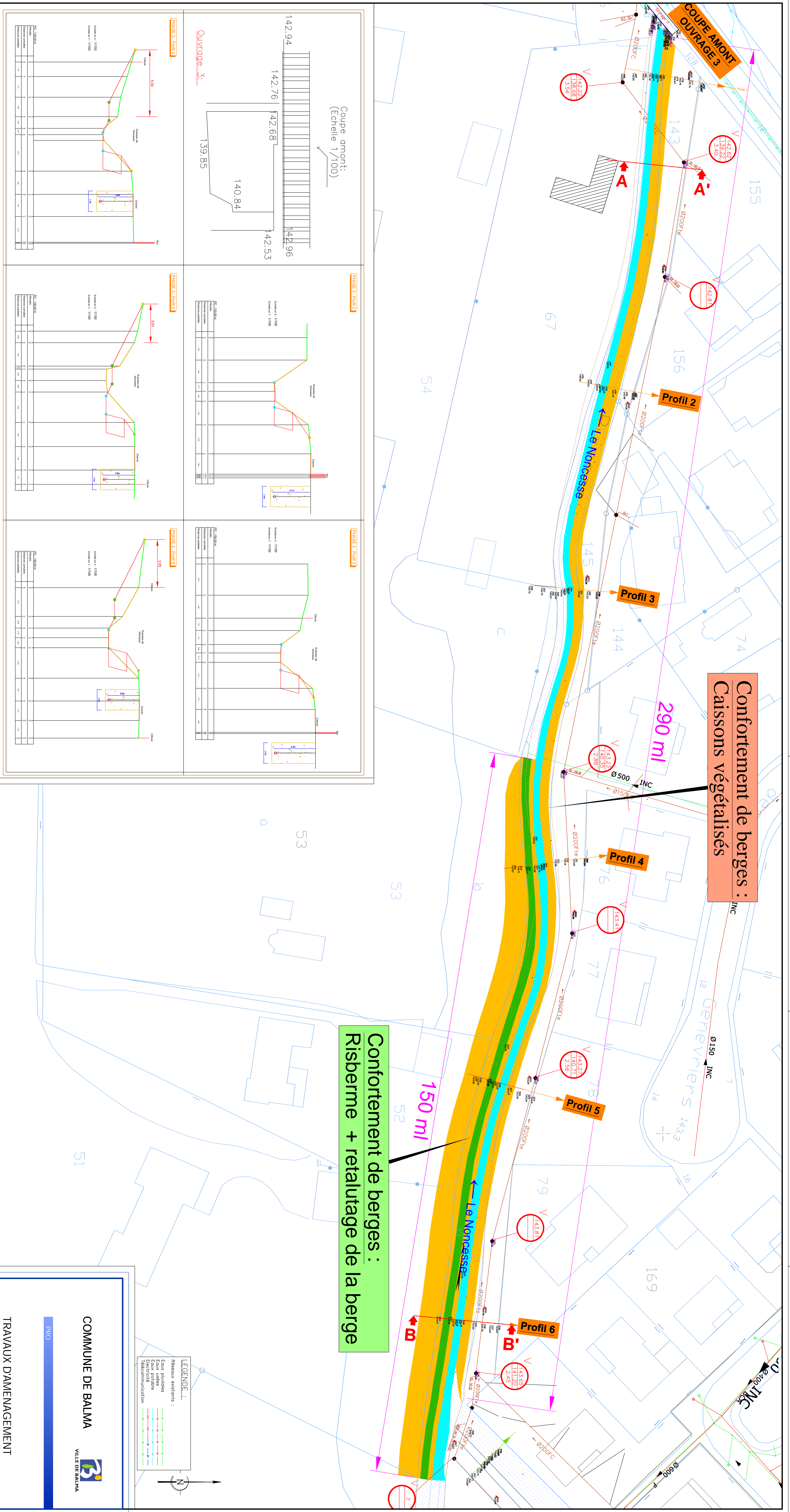

COUPE TYPE CAISSONS VEGETALISES - AA - Ech. : 1/50

LEGENDE DES PROFILS EN TRAVERS - Ech. : 1/100

COUPE TYPE RISBERME / CAISSONS VEGETALISES - CC - Ech. : 1/50

COMMUNE DE BALMA
VILLE DE BALMA

PRO

**TRAVAUX D'AMENAGEMENT
DU RUISSEAU DU NONCESSE**

AMENAGEMENTS PHASE 3

N° grille : TD 1006
Parti N° 03

Naldeo
Travaux de confortement de berges et élargissement

01	26/01/2015	Modification travaux risberme gauche	AL	PT
02	26/01/2015	Projet	AL	PT
03	26/01/2015	Projet	AL	PT
04	26/01/2015	Projet	AL	PT
05	26/01/2015	Projet	AL	PT
06	26/01/2015	Projet	AL	PT
07	26/01/2015	Projet	AL	PT
08	26/01/2015	Projet	AL	PT
09	26/01/2015	Projet	AL	PT
10	26/01/2015	Projet	AL	PT
11	26/01/2015	Projet	AL	PT
12	26/01/2015	Projet	AL	PT
13	26/01/2015	Projet	AL	PT
14	26/01/2015	Projet	AL	PT
15	26/01/2015	Projet	AL	PT
16	26/01/2015	Projet	AL	PT
17	26/01/2015	Projet	AL	PT
18	26/01/2015	Projet	AL	PT
19	26/01/2015	Projet	AL	PT
20	26/01/2015	Projet	AL	PT

RESEAUX EXISTANTS :
Eaux pluviales
Eaux usées
Eaux potables
Télécommunication